

CONVENIENTLY CONNECTED TO KEY DESTINATIONS WITHIN 15KM

15公里范围内覆盖各大核心目的地

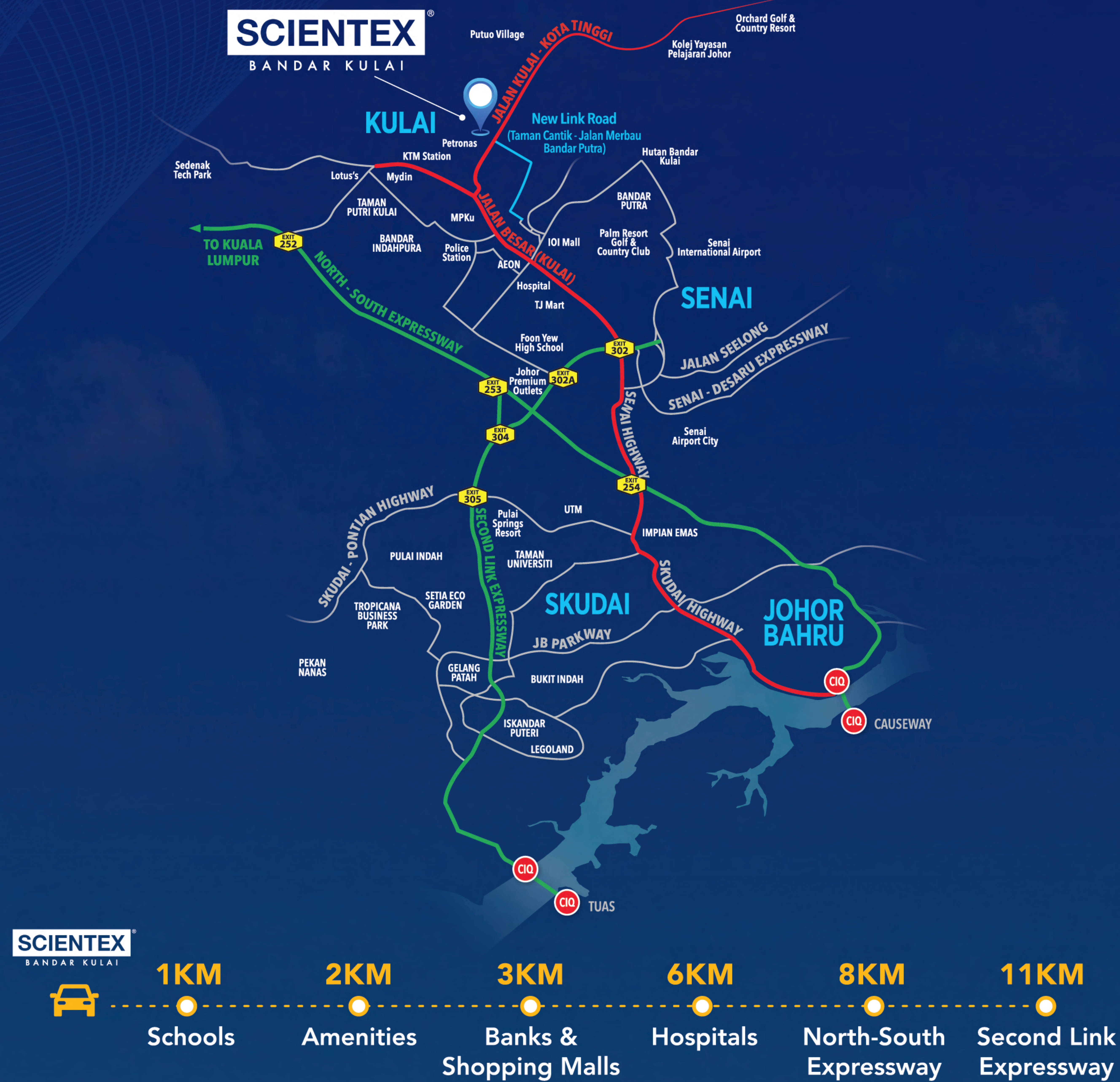

SCIENTEX[®]

BANDAR KULAI

SIGNATURE AVENUE

2 STOREY SHOP OFFICE 双层商店办公楼

**A NEW BUSINESS LANDMARK
A NEW HEIGHT OF GROWTH**

全新商业地标 · 腾飞新高度



07-663 3350
www.scientex.com.my



SCIENTEX LESTARI SDN. BHD.
202301017345 (1511267-T) (Subsidiary of Scientex Berhad)
Pejabat Jualan Taman Scientex Kulai 3, PTD 112804,
Jalan Kulai-Kota Tinggi, Ladang Golden Hope,
81000 Kulai, Johor Darul Takzim.
E-mail: kulai@scientex.com.my

This advertisement brochure represents an invitation and introduction to prospective purchasers to learn more about our project. A binding contract will only arise upon the signing of the prescribed Sale and Purchase Agreement between the parties.
本广告宣传册仅作为对潜在购房者的邀请与项目简介，旨在帮助您更深入了解我们的发展项目。具有法律效力的合约，仅限于双方签署指定的买卖合同 (Sale and Purchase Agreement).

SCIENTEX BANDAR KULAI
GPS Coordinates
1.679211, 103.613889



SCIENTEX
Healthy, Friendly & Happy

FREEHOLD 永久地契



7 KEY BENEFITS

YOUR GATEWAY TO GROWTH & SUCCESS
 成长与成功的门户



Strategic Connectivity
 便捷交通网络
 Easy access to highways, Senai Airport, and surrounding townships
 衔接高速公路、士乃机场及周边城镇



Integrated Township
 综合城镇规划
 Within a master-planned township of ~8,000 homes
 坐落于约 8,000 户的综合城镇内



Large Catchment Area
 庞大客群覆盖
 Up to 170,000 residents within 5km
 5公里内约17万居民



Retail & Lifestyle
 生活便利配套
 Surrounded by malls, banks, schools & resorts
 商场、银行、学校与度假配套齐全



Ample Parking
 充足泊车规划
 Designed for customer convenience
 提升顾客便利性



Freehold Ownership
 永久地契
 Long-term security for business & investment
 经营与投资的长远保障



Future-Ready Growth
 发展潜力可期
 Part of Johor's growth corridor, near Singapore
 位处柔佛发展走廊，毗邻新加坡



FLOOR PLAN
 平面图

Standard Land Size
 标准土地面积 **22'x70'**

Built-up Area
 建筑面积 **3,080 sq.ft.**

SPECIFICATION
 建筑规格

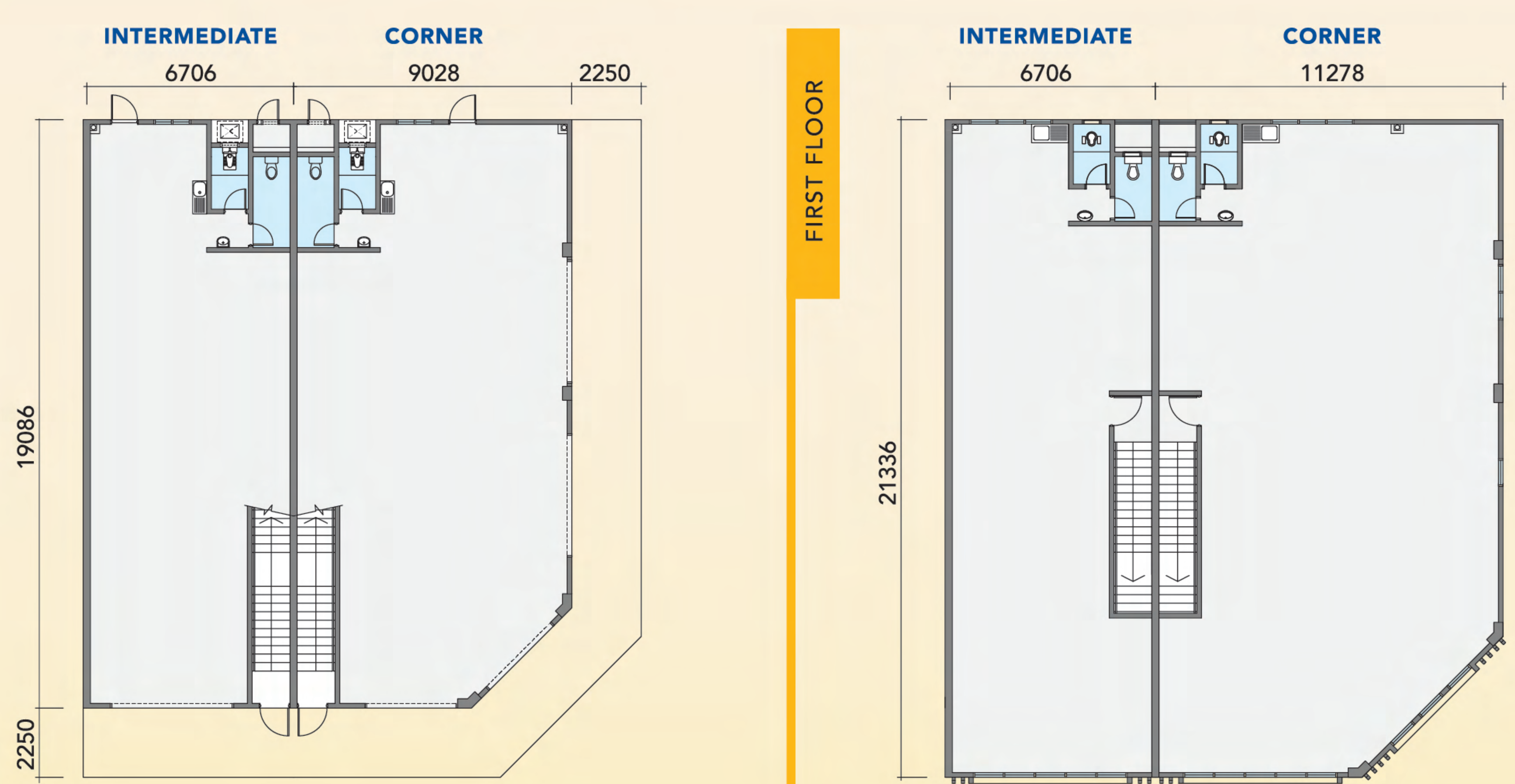

STRUCTURE	: Reinforced concrete frameworks
WALL	: Lightweight block with skim coat/ Cement sand plaster
ROOF COVERING	: Metal roofing sheet
ROOF FRAMING	: Proprietary Truss
CEILING	: Asbestos free ceiling board/ Skim coat plaster
DOORS	: Metal/ Plywood/ PVC flush door/ Metal roller shutter
WINDOWS	: Aluminium framed windows
IRONMONGERY	: Selected Lockset
WALL FINISHES	: Toilet - Selected tiles to 1.5m high
FLOOR FINISHES	: Shop - Cement render : Toilet - Tiles : Others - Cement render
SANITARY AND PLUMBING FITTINGS	: Quality sanitaryware complete with fittings
ELECTRICAL INSTALLATION	: Intermediate/ End Lots Corner Lot
Lighting Point	18 nos. 27 nos.
Ceiling Fan Point	2 nos. 2 nos.
13A Power Point	11 nos. 12 nos.
Telephone Point	2 nos. 2 nos.